

# HRP

**HEPFNER RACING PRODUCTS**

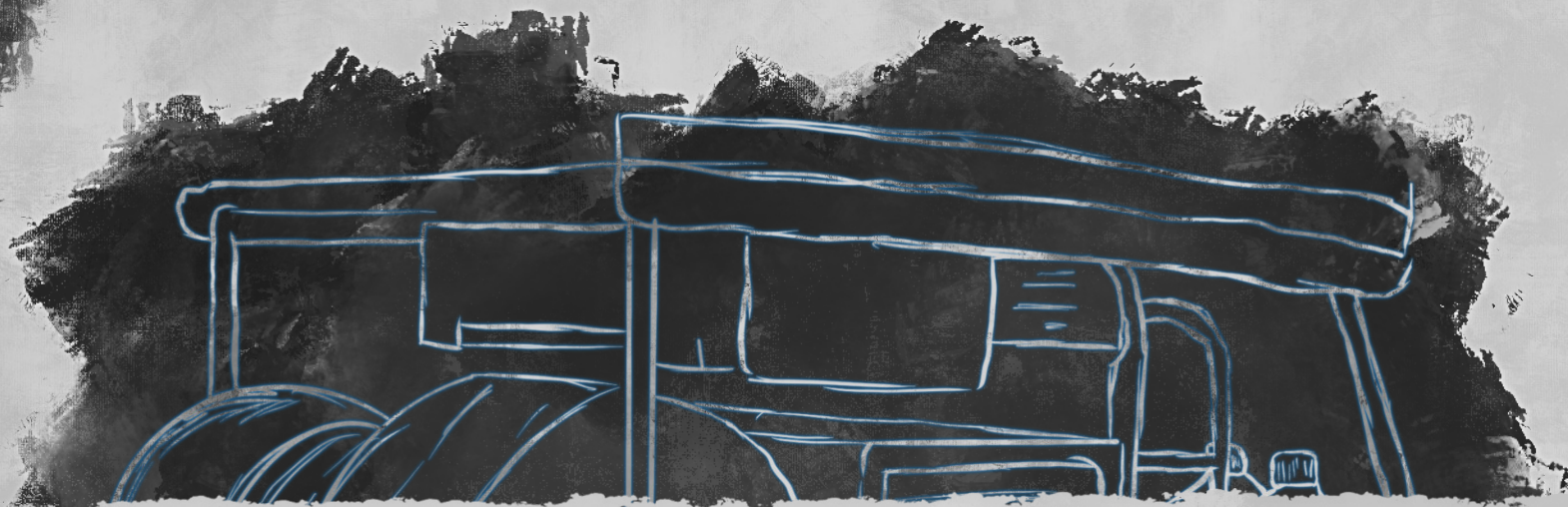

**INDUSTRY LEADING KAWASAKI MULE CONVERSIONS**

**CUSTOM CONVERSIONS - ADD ONS - ACCESSORIES - UPDATES**

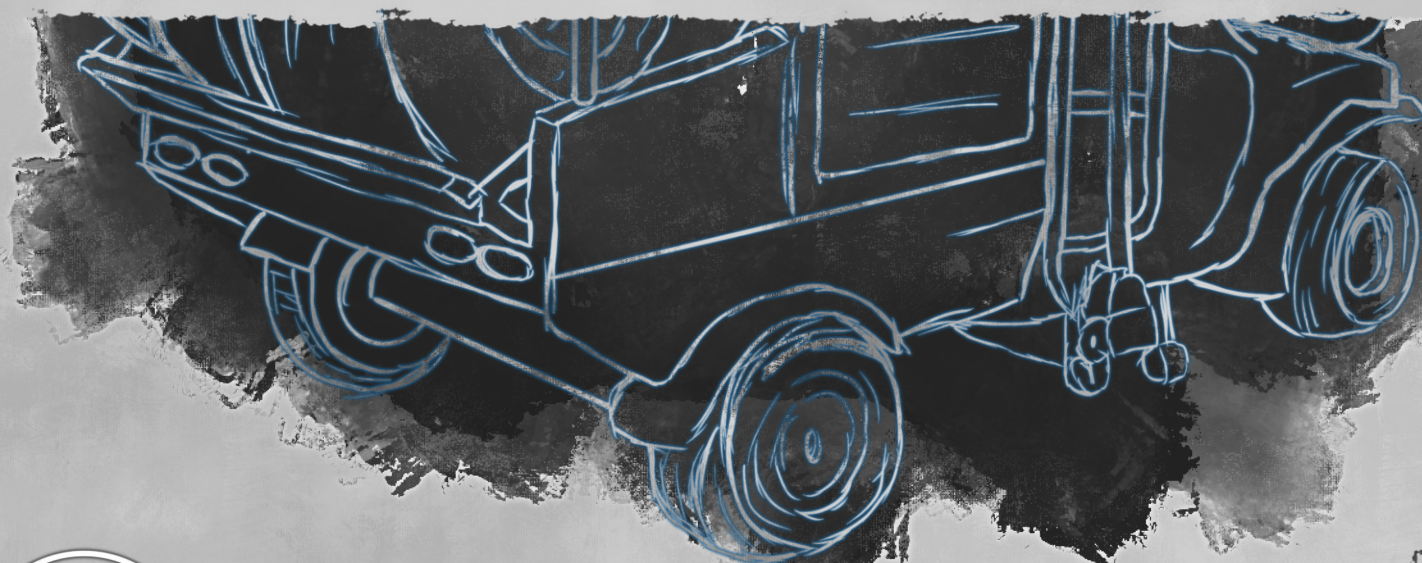

[hrpracing.com](http://hrpracing.com)



## Keeping Your Race Team On the Right Track Since 2002



# TABLE OF CONTENTS

## GENUINE HRP KAWASAKI MULE CONVERSIONS

Evolution of the Kawasaki Mule

3

Genuine HRP Kawasaki Mule Conversions

4

## HRP LARGE FORMAT CONVERSIONS

HRP Large Format Mule Conversions

5 - 6

## HRP SMALL FORMAT CONVERSIONS

HRP Small Format Mule Conversion

7

## HRP MULE CONVERSION OPTIONS, ADD-ONS, & ACCESSORIES

Small Rear Side Cabinet Options

8

Large Front Side Cabinet Options

9 - 10

Cabinet/Wall Mount Radius Rod Racks

11

Cabinet/Wall Mount Shock Racks & Spare Studs

12

Rear Mule Options

13 - 14

CTECH Drawer Stacks, Replacements, & Add-Ons

15

Drawer Organization

16

Painted Hoods, Jug Holder, & Tie Rod Rack

17

Nose Wing Mounts

18

Axle Racks, Clamp Rings, & Rear View Mirrors

19

Upper Decks & Options

20

Push Bars & Options; Shock Kits & Brackets

21

Jack Hangers, Ladders, Hoops, & Battery Upgrades

22

Fenders, Skirts, Brackets, & Trailers

23

Wheels, Covers, Brackets, Tubes, & Tires

24

Tool & Bolt On Holders

25 - 26





## PART NUMBER COLOR & FORMAT COMPATIBILITY

The Color of a Part Number Indicates its Series Compatibility. Be Sure to Choose the Products that Correspond to your Chosen Series When Outfitting or Building your HRP Mule Conversion.

Text Color	Example	Format Compatibility
Blue	<b>HRP0000</b>	BOTH Large & Small Format
Red	<b>HRP0000</b>	ONLY Large Format
Purple	<b>HRP0000</b>	ONLY Small Format
Black	<b>HRP0000</b>	Other



## HRP LARGE FORMAT CONVERSION

1990 - 2000 10" Wheel	2001 - 2008 10" Wheel	2009 - Present 10" Wheel
<b>2500 Series</b> - 2 x 4	<b>3000 Series</b> - 2 x 4	<b>4000 Series</b> - 2 x 4
<b>2510 Series</b> - 4 x 4	<b>3010 Series</b> - 4 x 4	<b>4010 Series</b> - 4 x 4

### LARGE FORMAT SPECS:

- 617 CC
- 4 Stroke 2 Cylinder
- OHV Liquid Cooled
- 1310# Loaded Capacity
- 800# Bed Capacity
- Current Models are Fuel Injected



## HRP SMALL FORMAT CONVERSION

2003 - 2004 10" Wheel	2005 - 2016 10" Wheel	2019 - Present 10" Wheel	2019 - Present 12" Wheel
<b>500 Series</b> - 2 x 4	<b>600 Series</b> - 2 x 4	<b>SX Series</b> - 2 x 4	<b>N/A</b>
<b>550 Series</b> - 4 x 4	<b>610 Series</b> - 4 x 4	<b>SX Series</b> - 4 x 4	<b>SX - XL Series</b> - 4 x 4

### SMALL FORMAT SPECS:

- 401 CC
- 4 Stroke Single Cylinder
- OHV Air Cooled
- 915# Loaded Capacity
- 400# Bed Capacity
- Current Models are Fuel Injected





# GENUNINE HRP KAWASAKI MULE CONVERSIONS

4





**LARGE FORMAT CONVERSION: FITS 2500, 2510, 3000, 3010, 4000, & 4010 SERIES**

## ENCLOSED DRAWER STACK

HRP6933-A



### LARGE FORMAT SPECS:

**Box Conversion:** 49.50" Wide x 38.75" Long x 44.75" Tall

**Complete Conversion:** 51.00" Wide x 114.00" Long x 73.00" Tall

**Dry Weight:** Approx. 2,000#

**Loaded Weight:** Approx. 2,500#

### STANDARD CONVERSION INCLUDES:

- Enclosed CTECH Drawers
- 30" & 20" Double Drawer Stack
- Top Deck
- HRP Side Cabinet Doors
- Adjustable Shelves
- Rear Fenders & Skirts





# LARGE FORMAT CONVERSION - EXPOSED DRAWERS



**LARGE FORMAT CONVERSION: FITS 2500, 2510, 3000, 3010, 4000, & 4010 SERIES**

## EXPOSED DRAWER STACK

HRP6932



### LARGE FORMAT SPECS:

**Box Conversion:** 49.50" Wide x 38.75" Long x 44.75" Tall

**Complete Conversion:** 51.00" Wide x 114.00" Long x 73.00" Tall

**Dry Weight:** Approx. 2,000#

**Loaded Weight:** Appox. 2,500#

### STANDARD CONVERSION INCLUDES:

- Exposed CTECH Drawers
- 30" & 20" Double Drawer Stack
- Top Deck
- HRP Side Cabinet Doors
- Adjustable Shelves
- Rear Fenders & Skirts





1

# SMALL FORMAT CONVERSION - EXPOSED DRAWERS

**SMALL FORMAT CONVERSION: FITS 550, 600, SX, & SX-XC SERIES**

## EXPOSED DRAWER STACK

HRP6934-A



### LARGE FORMAT SPECS:

**Box Conversion:** 41.75" Long x 49.50" Wide x 42.50" Tall

**Dry Weight:** Approx. 1,400#

**Loaded Weight:** Approx. 1,750#

### STANDARD CONVERSION INCLUDES:

- Exposed CTECH Drawers
- 40" Single Drawer Stack
- Top Deck
- HRP Name Plate
- HRP Side Cabinet Doors
- Adjustable Shelves
- Rear Fenders & Skirts

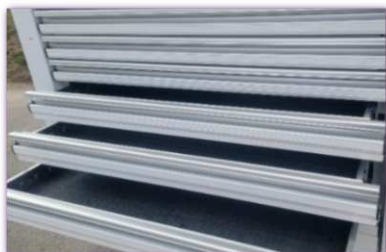



## SMALL REAR SIDE CABINET OPTIONS

Choose 2 Configurations: (1 Driver Side & 1 Passenger Side)  
- 2 Rear Door Props are Included with Each Configuration

Part No.	Description
<b>Swing Open Cabinets</b>	
<b>HRP6926-5</b>	5 Position Shock
<b>HRP6926-4SS</b>	4 Position Super Shock
<b>HRP6926-7</b>	7 Position Shock
<b>HRP6926-GEAR</b>	6 Position Gear Cabinet & Tray
<b>HRP6926-AC</b>	Aerosol Can Cabinet
<b>HRP6926-AC-600</b>	Aerosol Can Cabinet
<b>HRP6926-ET</b>	Empty Cabinet
<b>Fold Down Cabinets</b>	
<b>HRP6926-FD-DEEP</b>	4 Position Shock Cabinet
<b>HRP6925</b>	Empty Fold Down Work Tray

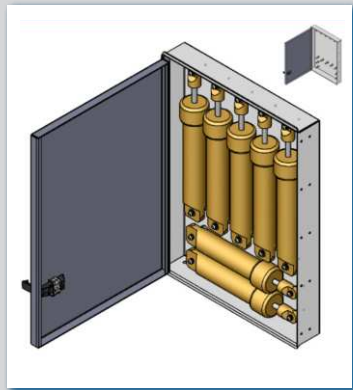

**7 Position Shock Cabinet**  
- Shocks are NOT Included

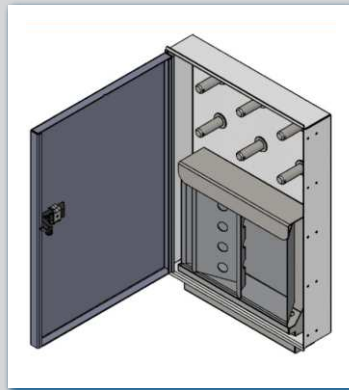

**Gear & Tray Cabinet**  
- Holds 3 Gear Sets  
- Includes Removable Sump to Catch Oil

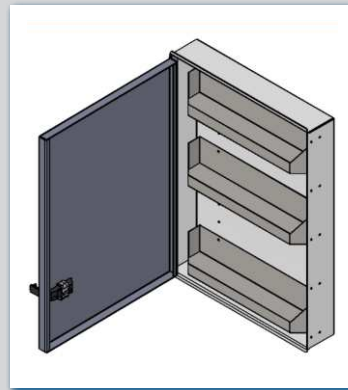

**Aerosol Can Cabinet**  
- Holds up to 25.0" Dia. Container

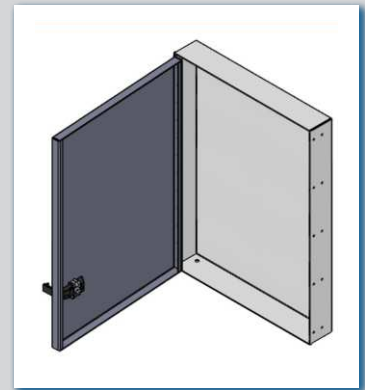

**Empty Cabinet**  
- To be Outfitted by Customer

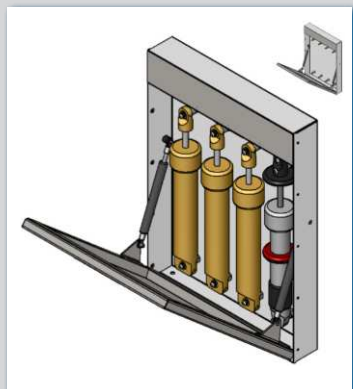

**4 Position Shock Cabinet**  
- Shocks are NOT Included

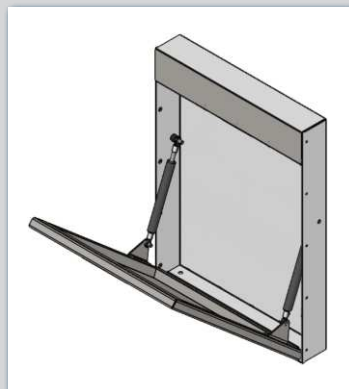

**Empty Work Tray**

### REPLACEMENT CABINET DOOR PROP

2 Props Needed for Each Small Rear Side Cabinet Configuration  
- Sold Each

**HRP6966-155**





## ADJUSTABLE SHELVES

Sold as a Set, (1 Shelf & 2 Brackets)

- 2 Sets are Included with Conversion

Part No.	Description
<b>HRP6956-D1</b>	Driver Side Shelf
<b>HRP6956-P1</b>	Passenger Side Shelf
<b>HRP6956-P2</b>	Passenger Side Torsion Bar Rack
<b>HRP6956-600-A</b>	Universal Side Shelf Standard Deep
<b>HRP6956-600-B</b>	Universal Side Torsion Bar Rack
<b>HRP6956-600-C</b>	Universal Side Shallow Torsion Bar Rack



## WHEEL WRENCH BRACKETS

Fits Most Wheel Wrenches

- Upper & Lower Bracket Sold Separately

Part No.	Description
<b>HRP6971-101</b>	Upper Bracket
<b>HRP6971-102</b>	Lower Bracket



Upper Bracket



Lower Bracket



## TORSION BAR RACK

Fits up to 30" Bars

Part No.	Description
<b>HRP6959</b>	15 Spots
<b>HRP6959-600</b>	9 Spots





## 120 VOLT POWER AIR COMPRESSOR KIT

Provides Power for Battery Chargers, Lights, Power Outlets, Etc.

### Kit Includes:

- Inverter/Charger
- Ultra Quiet Air Compressor
- Hose Reel
- Electrical Cord Reel
- 120 Volt Mule Conversion Wiring

Part No.	Description
<b>HRP6950</b>	Large Format
<b>HRP6950-600</b>	Small Format



## AEROSOL TRAYS

Optional Add-On Trays to Maximize Storage Space Within the Large Front Side Cabinets

- Can be Mounted on the Passenger & Driver Side

Width	14.25" Long	17.25" Long
2.50"	<b>HRP6964-250-14</b>	<b>HRP6964-250-17</b>
3.00"	<b>HRP6964-300-14</b>	<b>HRP6964-300-17</b>
3.25"	<b>HRP6964-325-14</b>	<b>HRP6964-325-17</b>
3.50"	<b>HRP6964-350-14</b>	<b>HRP6964-350-17</b>
4.00"	<b>HRP6964-400-14</b>	<b>HRP6964-400-17</b>

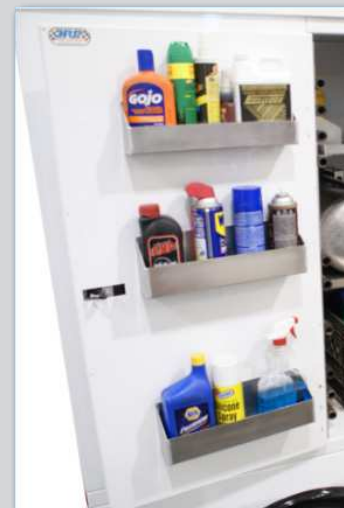

## BATTERY CHARGER KIT

Battery Charger Kit Includes 120 Volt Wiring

- Use Australian Wiring with Kit if Needed

Description	Large Format	Small Format
Battery Charger Kit	<b>HRP6901-BT-KIT</b>	<b>HRP6901-BT-600-KIT</b>
Australian Wiring	<b>HRP6901-BT-KIT-AUS</b>	<b>HRP6901-BT-600-KIT-AUS</b>





## CABINET/WALL MOUNT RADIUS ROD RACKS

Build Your Radius Rod Rack: Finish with 2 Different Part Numbers

1) Select Desired Width			
15" Wide		20" Wide	
<div><div></div><div></div></div>			
2) Select a Corresponding Upper Tray with Desired Amount of Rows/Spots			
Single Row (6 Rods)	Double Row (12 Rods)	Single Row (8 Rods)	Double Row (16 Rods)
○● <b>HRP6523S-15-(WHT/BLK)</b> \$88.20	○● <b>HRP6521D-15-(WHT/BLK)</b> \$104.74	○● <b>HRP6523S-20-(WHT/BLK)</b> \$99.25	○● <b>HRP6521D-20-(WHT/BLK)</b> \$123.50
<div><div></div><div></div><div></div><div></div></div>			
3) Select a Corresponding Lower Tray that Fits the Desired Diameter Rods			
<b>1.125" Dia. Rods:</b> ○● <b>HRP6523S-15B-(WHT/BLK)</b> \$40.30	<b>1.125" Dia. Rods:</b> ○● <b>HRP6521D-15B-(WHT/BLK)</b> \$40.30	<b>1.125" Dia. Rods:</b> ○● <b>HRP6523S-20A-(WHT/BLK)</b> \$42.50	<b>1.125" Dia. Rods:</b> ○● <b>HRP6521D-20A-(WHT/BLK)</b> \$42.50
<b>1.250" Dia. Rods:</b> ○● <b>HRP6523S-15C-(WHT/BLK)</b> \$40.30	<b>1.250" Dia. Rods:</b> ○● <b>HRP6521D-15C-(WHT/BLK)</b> \$40.30	<b>1.250" Dia. Rods:</b> ○● <b>HRP6523S-20D-(WHT/BLK)</b> \$42.50	<b>1.250" Dia. Rods:</b> ○● <b>HRP6521D-20D-(WHT/BLK)</b> \$42.50
<i>N/A</i>	<b>1" Dia. Rods:</b> ○● <b>HRP6521D-15A-(WHT/BLK)</b> \$40.30	<b>1" &amp; 1.250" Dia. Rods:</b> ○● <b>HRP6523S-20B-(WHT/BLK)</b> \$42.50	<b>1" &amp; 1.250" Dia. Rods:</b> ○● <b>HRP6521D-20B-(WHT/BLK)</b> \$42.50
<i>N/A</i>	<i>N/A</i>	<b>1.125" &amp; 1.250" Dia. Rods:</b> ○● <b>HRP6523S-20C-(WHT/BLK)</b> \$42.50	<b>1.125" &amp; 1.250" Dia. Rods:</b> ○● <b>HRP6521D-20C-(WHT/BLK)</b> \$42.50



## 15" EXAMPLE:

- 1) 15" Wide
- ↓
- 2) Double Row (12 Rods):  
**HRP6521D-15-(WHT/BLK) x1**
- ↓
- 3) 1.125" Dia. Rods:  
**HRP6521D-15B-(WHT/BLK) x1**



## 20" EXAMPLE:

- 1) 20" Wide
- ↓
- 2) Single Row (8 Rods):  
**HRP6523S-20-(WHT/BLK) x1**
- ↓
- 3) 1.125" & 1.250" Dia. Rods:  
**HRP6523S-20C-(WHT/BLK) x1**

MICRO SPRINT  
RADIUS ROD RACK

- Single Row (9 Positions)
- 20" Wide
- Upper & Lower Tray Included
- Includes (3) 0.437" & (6) 0.375" Dia. Pins

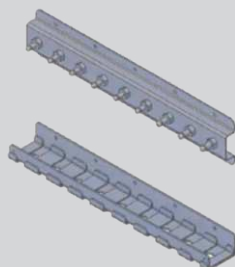
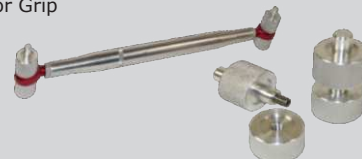
● **HRP6540-C** \$136.10RADIUS ROD RACK  
MEASURING BOSSQuickly Adjust & Match the Replacement  
- Knurled Edges for Superior Grip● **HRP6208** \$62.40

## CABINET/WALL MOUNT SHOCK RACKS

**Build Your Shock Rack:** Finish with 2 of the Same Part Numbers (Sold Each: 2 Racks = 1 Complete Set)

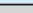
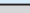
1) Select Desired Width			
15" Wide		20" Wide	
			
2) Select a Corresponding Upper Tray with Desired Amount of Rows/Spots			
Single Row (6 Rods)	Double Row (12 Rods)	Single Row (8 Rods)	Double Row (16 Rods)
○● <a href="#">HRP6524S-15-(WHT/BLK)</a> \$88.20	○● <a href="#">HRP6522D-15-(WHT/BLK)</a> \$88.20	○● <a href="#">HRP6524S-20-(WHT/BLK)</a> \$99.20	○● <a href="#">HRP6522D-20-(WHT/BLK)</a> \$126.80



### 15" EXAMPLE:

- 1) 15" Wide
- 2) Double Row (12 Rods):  
**HRP6522D-15-(WHT/BLK) x2**



### 20" EXAMPLE:

- 1) 20" Wide
- 2) Single Row (8 Rods):  
**HRP6524S-20-(WHT/BLK) x2**

## SPARE STUDS

Sold Each

See Rue Ring Clips on Page #44

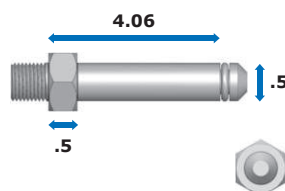
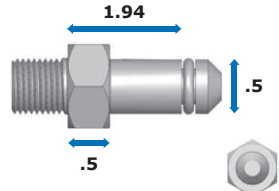
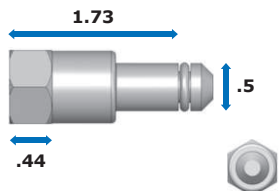
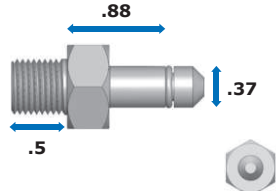
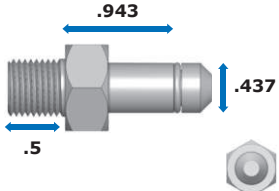
Radius Rod Rack Studs				
 <p>4.06 .5 .5</p>	 <p>1.94 .5 .5</p>	 <p>1.73 .5 .44</p>	 <p>.88 .37 .5</p>	 <p>.943 .437 .5</p>
Double <b>HRP6525</b>	Single <b>HRP6527</b>	Single <b>HRP6533</b>	Single <b>HRP6534</b>	Single <b>HRP6535</b>

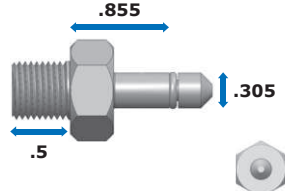
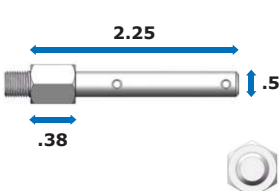
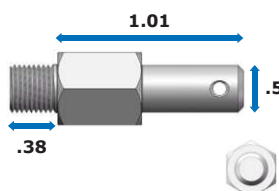
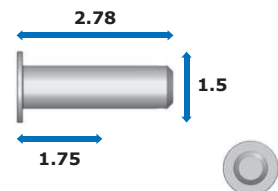
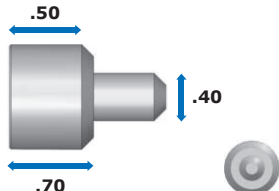
Radius Rod Rack Stud	Shock Rack Stud	Shock Rack Stud	Gear Pin Boss	Steering Rod Pin
 <p>.855 .305 .5</p>	 <p>2.25 .5 .38</p>	 <p>1.01 .5 .38</p>	 <p>2.78 1.5 1.75</p>	 <p>.50 .40 .70</p>
Single <b>HRP6536</b>	Double <b>HRP6526</b>	Single <b>HRP6528</b>	<b>HRP6537</b>	<b>HRP6538</b>



## 12 VOLT LIGHTS

Generator Kit Needed to Power Lights (Page #6)

**The Large Format 12 Volt LED Light Kit Includes 3 Light Strips:**

- 1 Upper Light Strip in the Front Passenger Side Cabinet
- 1 Upper Light Strip in the Front Driver Side Cabinet
- 1 Lower Light Strip Above the Rear Door Shelf

**HRP6951**

**The Small Format 12 Volt LED Light Kit Includes 2 Light Strips:**

- 1 Upper Light Strip Between the Front Driver & Passenger Side Cabinet
- 1 Lower Light Strip Above the Rear Door Shelf

**HRP6951-600**

**The Universal Format Add-On Lower Bar Includes 2 Light Strips:**

- 2 Upper Light Strips on the Upper Enclosed Rear Door

**HRP6951-DL**



## CARPETED SIDES & FRONT BOARD

Mount Anything by Using Sheet Metal Screws

- .75" Plywood Construction

Description	Large Format	Small Format
Battery Charger Kit	<b>HRP6901-BT-KIT</b>	<b>HRP6901-BT-600-KIT</b>
Australian Wiring	<b>HRP6901-BT-KIT-AUS</b>	<b>HRP6901-BT-600-KIT-AUS</b>



## MULTI PURPOSE UTILITY TRAY

Battery Packs, Tools, Parts, & More

- 8" x 16"
- Aluminum
- Custom Finishes Available

**HRP6963**

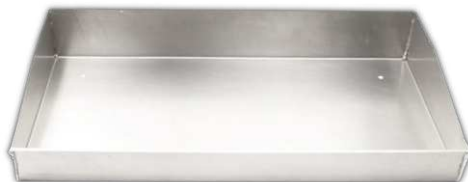

## TOWEL BOX TRAY

Fits Shop Towel Box, See on Page #22

- 9.75" x 10.75"
- Aluminum
- Custom Finishes Available

**HRP6962**



## LED TAIL LIGHTS & GROMMETS

Included with Conversion  
- Grommets Include Wiring Pigtails

Part No.	Description
<b>Circle Style</b>	
<b>HRP6924-R</b>	LED Light
<b>HRP6924-G</b>	Grommets
<b>Oval Style</b>	
<b>HRP6924-R-OVAL</b>	LED Light
<b>HRP6924-G-OVAL</b>	Grommets



2022 & Older HRP Conversions Use Circle Style Tail Lights



2023 & Newer HRP Conversions Use Oval Style Tail Lights

## BACKUP CAMERA KIT

Hangs From Roof

**HRP6906-B-ASSY**

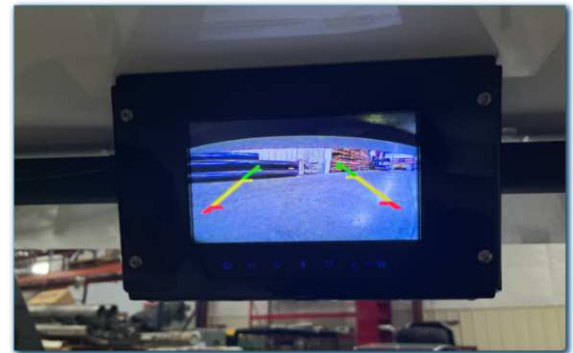

## CUSTOM NAME PLATES

Powder Coated Metal

Part No.	Description
<b>HRP6952-S</b>	Simple Design
<b>HRP6952-C</b>	Complex Design
<b>HRP6952-P</b>	Plastic Replacement



## HRP NAME PLATE

Included with Conversion



## REAR DOOR PROPS

2 Included with Conversion  
- Sold Each

Drawer Style	Large Format	Small Format
Exposed Drawers	<b>HRP6966-30</b>	<b>HRP6966-20</b>
Enclosed Drawers	<b>HRP6966-70</b>	-





## CTECH DRAWER STACKS

Drawer Stacks & Stock Colors Included With Conversion

- Custom Colors Available at Extra Charge



Description	20" Wide - 8 Drawers	30" Wide - 8 Drawers	40" Wide - 6 Drawers
<b>CTECH Drawer Stacks</b>			
CTECH Drawers	<b>HRP6940-20</b>	<b>HRP6940-30</b>	<b>HRP6940-40</b>
<b>Replacement Drawer Components</b>			
4" Long Faces	<b>HRP6940-20-F4</b>	<b>HRP6940-30-F4</b>	<b>HRP6940-40-F4</b>
6" Long Faces	<b>HRP6940-20-F6</b>	<b>HRP6940-30-F6</b>	<b>HRP6940-40-F6</b>
Drawer Handles	<b>HRP6940-20-H</b>	<b>HRP6940-30-H</b>	<b>HRP6940-40-H</b>
<b>Drawer Mats, Foam, &amp; Carpet</b>			
Drawer Mat	<b>HRP6909-20-MAT</b>	<b>HRP6909-30-MAT</b>	<b>HRP6909-40-MAT</b>
Drawer Foam	<b>HRP6909-20-FOAM</b>	<b>HRP6909-30-FOAM</b>	<b>HRP6909-40-FOAM</b>
Drawer Carpet	<b>HRP6909-20-CARPET</b>	<b>HRP6909-30-CARPET</b>	<b>HRP6909-40-CARPET</b>
Upper Shelf Mat	<b>HRP6908-MAT</b>	<b>HRP6908-MAT</b>	<b>HRP6908-40-MAT</b>
Upper Shelf Carpet	<b>HRP6908-CARPET</b>	<b>HRP6908-CARPET</b>	<b>HRP6908-40-CARPET</b>



## BLACK DRAWER HANDLE UPGRADE

Upgrade from Silver Handles

- Includes Necessary Amount of Handles for a Complete Drawer Stack

**HRP6940-BLK-HANDLES**

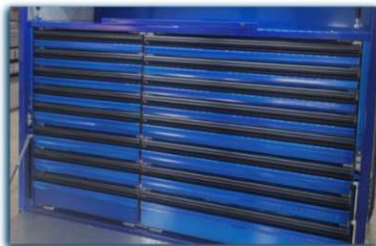

## CUSTOM DRAWER ORGANIZATION

Call for Specs, Pricing, & Options

- Tool Trays  
- Socket & Ratchet Trays



## DRAWER SLIDE TRAY

Plastic Glide Rail for Smooth Opening & Closing

Part No.	Description
<b>HRP6910-20</b>	Fits 20" Drawer Stack, (20" Wide)
<b>HRP6910-30</b>	Fits 30" Drawer Stack, (30" Wide)
<b>HRP6910-40</b>	Fits 40" Drawer Stack, (40" Wide)

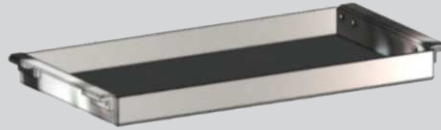

## FULL WRENCH TRAY

25" x 11" x 1.25"  
- 9 Compartments

**HRP6115-7**



## WRENCH RACKS

Bare Aluminum

Part No.	Spots	Fits
<b>Open End/Ratchet Box End</b>		
<b>HRP6120-F</b>	13	1/4" - 1"
<b>HRP6121-B</b>	9	1/4" - 3/4"
<b>HRP6121-F</b>	9	1/4" - 3/4"

Part No.	Spots	Fits
<b>Open End/Ratchet Box End</b>		
<b>HRP6122-F</b>	8	5/16" - 3/4"
<b>HRP6123-B</b>	4	5/16" - 3/4"
-	-	-



## TOOL & PART TRAYS

Pliers, Screwdrivers, Cutters, Specialty Tools, Parts, & More

Length	2.0" Wide	2.5" Wide	3.0" Wide	3.5" Wide	4.0" Wide	6.0" Wide
4.0"	<b>HRP6152A</b>	<b>HRP6153A</b>	<b>HRP6154A</b>	<b>HRP6155A</b>	<b>HRP6156A</b>	-
6.0"	<b>HRP6152B</b>	<b>HRP6153B</b>	<b>HRP6154B</b>	<b>HRP6155B</b>	<b>HRP6156B</b>	<b>HRP6157B</b>
8.0"	<b>HRP6152C</b>	<b>HRP6153C</b>	<b>HRP6154C</b>	<b>HRP6155C</b>	<b>HRP6156C</b>	-
10.0"	<b>HRP6152D</b>	<b>HRP6153D</b>	<b>HRP6154D</b>	<b>HRP6155D</b>	<b>HRP6156D</b>	-
12.0"	<b>HRP6152E</b>	<b>HRP6153E</b>	<b>HRP6154E</b>	<b>HRP6155E</b>	<b>HRP6156E</b>	-

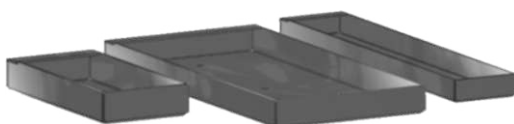



## PAINTED HOODS

- Stock Colors & Lin-X Included with Conversion
- Custom Colors Available at Extra Charge

Series:	3000	4000	4000 Lin-X	600	SX	600/SX Lin-x
Part No:	HRP6989	HRP6989-4000	HRP6989-4000-LINX	HRP6989-600	HRP6989-SX	HRP6989-600-LINX



## UTILITY JUG HOLDER

Utility Jugs Available on Page #22

- Stock Colors Included
- Custom Colors Available at Extra Charge
- Holds 2 Jugs
- Brackets Included

HRP6980-4000



## HEADACHE BOARD TIE ROD RACK

4 Plastic Tie Rod Holders are Included with Tie Rod Rack

- Stock Colors Included
- Custom Colors Available at Extra Charge

Part No.	Description
HRP6972-H	Head Rack
HRP6972-A	Under Deck
HRP6937	Replacement Tie Rod Holders



## FRONT HANGING STYLE NOSE WING MOUNT

Hangs 1 Sprint Car Nose Wing Below the Top Deck **Without** the Need of a Bungee Cord  
- Aluminum

Part No.	Finish
<a href="#">HRP6978-HD-WHT</a>	White
<a href="#">HRP6978-HD-BLK</a>	Black



## FRONT HANGING STYLE NOSE WING MOUNT

Hangs 1 Sprint Car Nose Wing Below the Top Deck **With** the Need of a Bungee Cord  
- 1 Bungee Cord Included  
- Aluminum

Part No.	Finish
<a href="#">HRP6978</a>	Bare
<a href="#">HRP6978-WHT</a>	White
<a href="#">HRP6978-BLK</a>	Black
<a href="#">HRP6978-SEMIBLK</a>	Semi Gloss Black



## NOSE WING HANGERS FOR HALF CABINET CONVERSIONS

### REAR SLIDE IN STYLE NOSE WING MOUNT

[HRP6977](#)



### REAR HANGING STYLE NOSE WING MOUNT

[HRP6979](#)





## MULE CONVERSION AXLE RACKS

Necessary Clamp Rings are Sold Separately (See Below)

- Rubber Edging where the Axle Sits
- Adjustable & Removable

Style:	Front Axle Rack	Front Axle Rack	Rear Axle Rack	Combo Axle Rack	Midget Axle Rack
Part No:	HRP6995	HRP6995-600	HRP6996	HRP6997	HRP6997-M



Front Axle Rack



Combo Axle Rack



Rear Axle Rack

## AXLE RACK CLAMP RINGS

4 Needed for Axle Rack Above

Part No.	Dia.	Series
HRP6998	1.69"	Large Format
HRP6998-600	1.89"	Small Format
HRP6999	1.75"	Polaris Ranger



## REAR VIEW MIRRORS

Clamp On Roll Cage Style

Part No.	Description
<b>Standard Option</b>	
HRP6935	Includes 1 Universal Mirror
<b>Upgraded Option (Fold In)</b>	
HRP6935-FG	Includes Left & Right Mirrors
HRP6935-FG-600	Includes Left & Right Mirrors

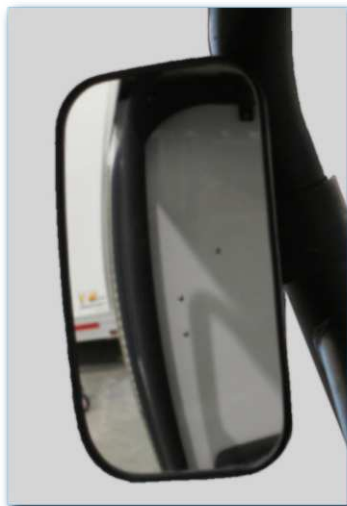

Standard

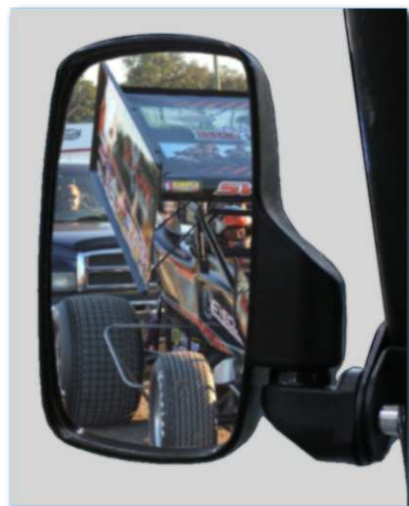

Upgraded

## MULE CONVERSION UPPER DECKS

Downward Roof Bend  
- .25" Aluminum

Series	Full Deck - Smooth	Full Deck - Diamond Plate	Add-On Front Deck	Lin-X Top Deck Surface
4000	<b>HRP6975-S</b>	<b>HRP6975-D</b>	<b>HRP6975-A</b>	<b>HRP6975-LINX</b>
600	-	-	<b>HRP6975-600</b>	<b>HRP6975-LINX-600</b>



Smooth



Diamond Plate



Lin-X

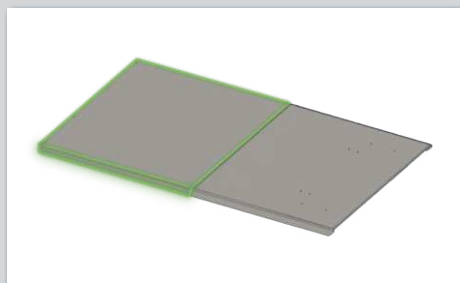

**\*Included\* Rear Deck**

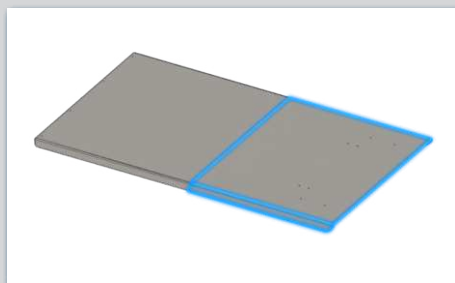

**\*Add-On\* Front Deck**

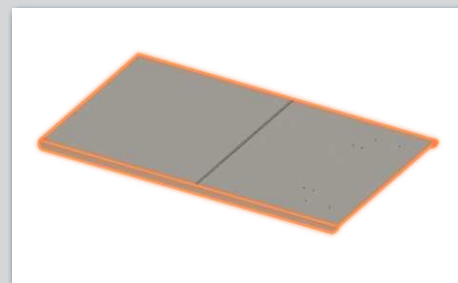

**Full Deck**

## BODY PANEL MOUNT

Store Spare Body Panels for Quick & Easy Access

- Hangs Under the Drivers Side
- Holds Up to 3.25" Long Panels

**HRP6987-A**

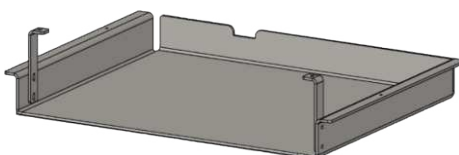

## K HANDLE ASSEMBLY

Our **NEW** K-Handle Makes it Much Easier & Safer to Climb Up & Down From the Roof

- Lock into Upright Position to Use
- Lays Down Flush When Not in Use

**HRP6973-500**

**Latching System**



**Flat "Resting" Position**

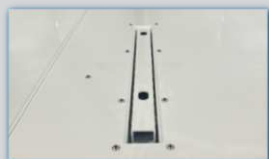



## PUSH BAR & BRACKETS

- Bracket Necessary for Installation (Sold Separately)
- Steel Construction & Black Delrin Push Surface
- 1 Included with Conversion

Push Bar - Universal Series				
HRP6985-F				
Bracket - Series Specific				
2500	3000	4000	600	SX
HRP6985-2500	HRP6985-3000	HRP6985-4000	HRP6985-600	HRP6985-SX



HRP6985-2500



HRP6985-3000



HRP6985-4000

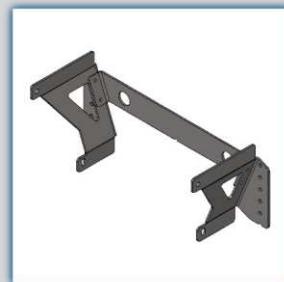

HRP6985-600



HRP6985-SX

## OPTIONAL PUSH BAR ADD-ONS

### TIE DOWN BRACKET

Increases Push Accuracy

- Add to Left Side, Right Side, or Both
- Sold Each

HRP6985



### RUBBER BUMPER KIT

Added Cushion when Pushing Sprint Car

- Bracket Included

HRP6985-R



## COIL OVER SHOCK KITS & BRACKETS

Brackets are Sold Separately (Necessary for Installation)

- Shock Kits Include 2 Shocks
- Bracket Kits Include LH & RR

Part No.	Description
HRP6961-ALUM	Aluminum Shock Kit
HRP6961-STEEL	Steel Shock Kit
HRP6991-4000-KIT	Bracket
HRP6991-600-KIT	Bracket



## JACK HANGERS

Black Coated Steel

- 1 Included with Conversion

Part No.	Width
HRP6988-4000-16	16"
HRP6988-600-16	16"
HRP6988-18	18"

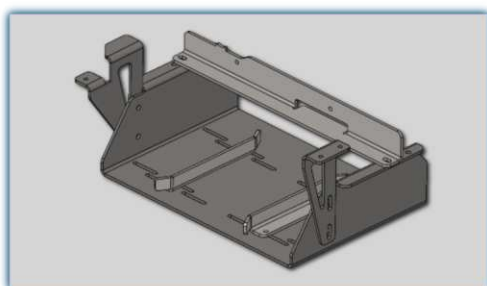

HRP6988-4000-16

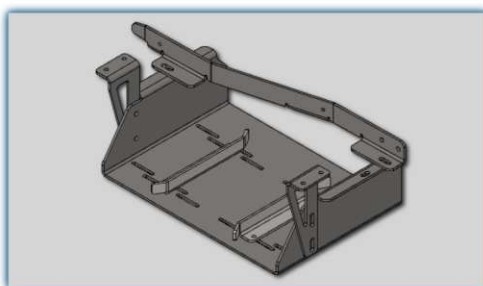

HRP6988-600-16

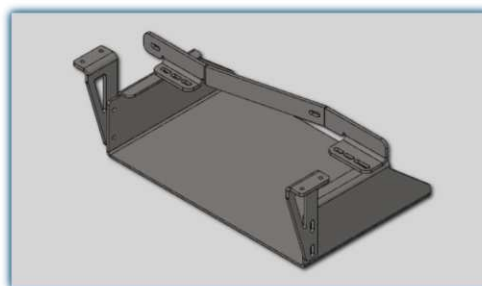

HRP6988-18

## BOLT ON LADDER

Black Coated Steel

- 1 Included with Conversion

Part No.	Series
HRP6974-4000	Large Format
HRP6974-600	Small Format



## HOOP

Holds the Jack Hanger in Position with the Ladder

- Clear Anodized Aluminum  
- 1 Included with Conversion

HRP6974-HOOP

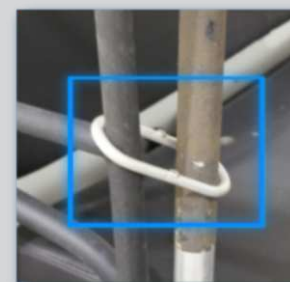

## BATTERY UPGRADE

HRP6948



## DUAL BATTERY UPGRADE

Call for Information





## FENDER SKIRTS

Fits **ONLY** HRP Mule Conversion Decks

- Powder Coated to Mule Specifications
- Steel & Aluminum Construction

Part No.	Description
<a href="#">HRP6969-LH-PRO</a>	Left Hand
<a href="#">HRP6969-RH-PRO</a>	Right Hand



## FENDER SKIRT BRACKET KIT

**Includes:**

- 1 LH Bracket
- 1 RH Bracket

[HRP6967](#)



## COMPLETE FENDER SET

**Set Includes:**

- Skirts
- Fenders
- Mounting Brackets

[HRP6968-SET](#)

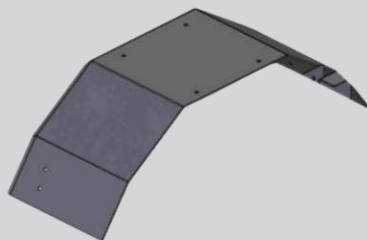

## STOCK BED FENDER SKIRTS

Fits **ONLY** Stock Mule Decks/Beds

- Includes [HRP6968-SET](#) Above

[HRP6969K-ASSY](#)

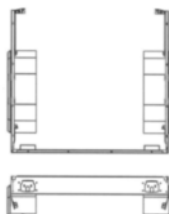

## KAWASAKI MULE TRAILERS

Hitch Included

Part No.	Description
<a href="#">HRP6928-B</a>	With Dump Feature
<a href="#">HRP6928-N</a>	Without Dump Feature



## MULE WHEEL COVERS

Bracket Necessary For Installation (Sold Separately)

Finish	10" Wheel	12" Wheel
Black	<b>HRP6994-BLK</b>	<b>HRP6994-12-BLK</b>
Semi Gloss Black	<b>HRP6994-SEMIBLK</b>	<b>HRP6994-12-SEMIBLK</b>
White	<b>HRP6994-WHT</b>	<b>HRP6994-12-WHT</b>
Bare (None)	<b>HRP6994-BARE</b>	<b>HRP6994-12-BARE</b>
Red Sanders	<b>HRP6993</b>	-
Yellow Weld	<b>HRP6994</b>	-



Black Finish



White Finish



Bare Finish



Red Sanders



Yellow Weld

## WHEEL COVER BRACKETS

Brackets Include Springs & Buttons

- Aluminum Construction
- 1 Set Included With Conversion

Series	10" Wheel	12" Wheel
Large Format	<b>HRP6992</b>	-
Small Format	<b>HRP6992-600</b>	<b>HRP6992-SX-12</b>



## TURF TIRES

Fits 10" Wheel

- Rims & Tires Sold Separately
- Sold Each

Part No.	Description
<b>HRP6947</b>	Carlisle (Aggressive)
<b>HRP6947-GP</b>	Golf Pro (Smooth)
<b>HRP6947-MID</b>	Moderate to Aggressive



**HRP6947**  
20 x 10.0 x 10



**HRP6947-GP**  
250/50-10



**HRP6947-MID**  
20 x 10.00 - 10

## KAWASAKI RIMS

Fits 10" Wheel

- Rims & Tires Sold Separate
- Sold Each

Part No.	Description
<b>HRP6946</b>	Large Format Rim
<b>HRP6946-600-F</b>	Small Format Front Rim
<b>HRP6946-600-R</b>	Small Format Rear Rim



## INNER TIRE TUBES

Fits 10" Wheel

- Sold Each

Part No.	Series
<b>HRP6945</b>	Large Format
<b>HRP6945-600</b>	Small Format





## CORDLESS DRILL & IMPACT HOLDER

### Set In Style

- Fits Both Drills & Impacts

Part No.	Finish
<a href="#">HRP6395-WHT</a>	White
<a href="#">HRP6395-BLK</a>	Black



## CORDLESS DRILL HOLDER

### Slide In Style

- Mounts Horizontally or Vertically

Part No.	Description
<a href="#">HRP6396-1-WHT</a>	Standard (2.57" I.D.)
<a href="#">HRP6396-WHT</a>	Adjustable (2.12" - 2.92" I.D.)



## UTILITY FUNNELS, HOLDERS, & FILTER

Part No.	Description
<a href="#">HRP6262-WHT</a>	Triangle Funnel Rack (White)
<a href="#">HRP6262-BLK</a>	Triangle Funnel Rack (Black)
<a href="#">HRP6262</a>	Triangle Funnel Rack (Bare)
<a href="#">BEH-366-55001406</a>	Triangle Funnel
<a href="#">BEH-366-55000001</a>	Funnel Filter



[HRP6262-WHT](#)



[BEH-366-55001406](#)



[BEH-366-55000001](#)

## TIRE TAPE RACK

Holds up to 3 Tire Tape Measures

[HRP6160](#) \$7.70

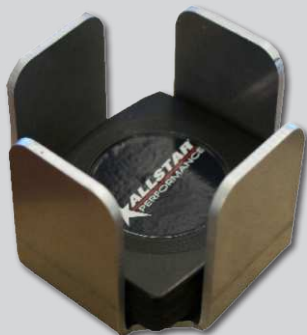

## TIRE TAPE

Perfect Fit for HRP's Tire Tape Rack

[HRP6823](#) \$5.70



## BOLT ON STYLE

### NITRO BOTTLE HOLDER

Sold as a Set (2)

HRP6060



## SET IN STYLE - 7"

### NITRO BOTTLE HOLDER

Part No.	Finish
HRP6059-WHT	White
HRP6059-BLK	Black



## TAPE MEASURE RACKS

Mounts to Toolbox Drawer  
- Bare Aluminum

Part No.	Description
HRP6161A	Medium, 3.360" Long
HRP6161B	Large, 4.360" Long



## RUE RING CLIPS

Bare Aluminum

Part No.	Dia.
HRP8409-250	0.250"
HRP8409-312	0.312"
HRP8409-375	0.375"
HRP8409-500	0.500"



## MOOSE BLOCKS HOLDER

Wall Mount  
- Holds up to 4 Moose Blocks  
- Bare Aluminum

HRP6142A

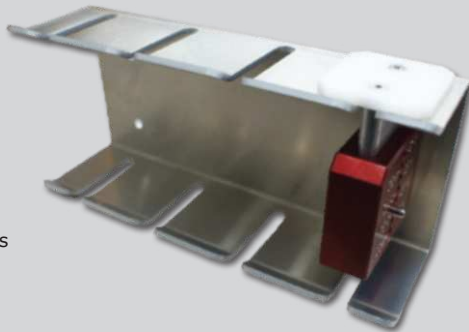

## MOOSE BLOCKS



Part No.	Description
HRP6253	Tall Setup
HRP6251	Short Setup



## UTILITY JUGS

Manufacture/Style May Vary

Part No.	Description
HRP6364	5 Gallon Jug
HRP6363	2.5 Gallon Jug



## SHOP TOWEL BOX

200 Count Heavy Duty Towels  
- Brand & Color May Vary

HRP6192







**GOTTA ROLL WITH THE BEST TO BE THE BEST**

***hrpracing.com***

**HEPFNER RACING PRODUCTS**

2133 Constitution Ave.  
Hartford, WI 53027

**HOURS**

8:00 am - 5:00 pm CST  
Monday - Friday

**CONTACT US VIA EMAIL**

hrpsales@ghilaser.com

**ORDER BY PHONE**

(262) 457-5015

**SHOP & ORDER ONLINE**

hrpracing.com

**PAYMENTS**

We Accept Visa, MasterCard, Discover, & AmEx. Financing is Available